

# CONTINENTAL GLASS SYSTEMS

## SERIES 3800 WALL WINDOW (SMI)

### GENERAL NOTES:

- THE PRODUCT SHOWN HEREIN IS DESIGNED AND MANUFACTURED TO COMPLY WITH THE CURRENT FLORIDA BUILDING CODE (FBC), INCLUDING HVHZ AND HAS BEEN EVALUATED ACCORDING TO THE FOLLOWING:
  - TAS 201-94
  - TAS 202-94
  - TAS 203-94
- ADEQUACY OF THE EXISTING STRUCTURAL CONCRETE/MASONRY, STEEL, AND 2X FRAMING AS A MAIN WIND FORCE RESISTING SYSTEM CAPABLE OF WITHSTANDING AND TRANSFERRING APPLIED PRODUCT LOADS TO THE FOUNDATION IS THE RESPONSIBILITY OF THE ENGINEER OR ARCHITECT OF RECORD FOR THE PROJECT OF INSTALLATION.
- 1X AND 2X BUCKS (WHEN USED) SHALL BE DESIGNED AND ANCHORED TO PROPERLY TRANSFER ALL LOADS TO THE STRUCTURE. BUCK DESIGN AND INSTALLATION IS THE RESPONSIBILITY OF THE ENGINEER OR ARCHITECT OF RECORD FOR THE PROJECT OF INSTALLATION.
- THE INSTALLATION DETAILS DESCRIBED HEREIN ARE GENERIC AND MAY NOT REFLECT ACTUAL CONDITIONS FOR A SPECIFIC SITE. IF SITE CONDITIONS CAUSE INSTALLATION TO DEVIATE FROM THE REQUIREMENTS DETAILED HEREIN, A LICENSED ENGINEER OR ARCHITECT SHALL PREPARE SITE SPECIFIC DOCUMENTS FOR USE WITH THIS DOCUMENT IN NON-HVHZ AREAS. IN HVHZ AREAS, ONE TIME PRODUCT APPROVAL TO BE OBTAINED FROM MIAMI-DADE PERA.
- APPROVED IMPACT PROTECTIVE SYSTEM **IS NOT REQUIRED** ON THIS PRODUCT IN AREAS REQUIRING SMALL IMPACT RESISTANCE.
- WINDOW FRAME MATERIAL: ALUMINUM 6005-T5
- DISSIMILAR METALS INCLUDING FASTENERS THAT MAY COME INTO CONTACT WITH ALUMINUM UNIT FRAMING SHALL BE PROTECTED AS DEFINED IN THE CURRENT FBC.
- GLASS MEETS THE REQUIREMENTS OF ASTM E 1300-04 GLASS CHARTS. SEE SHEET 1 FOR GLAZING DETAIL.
- APPROVED STRUCTURAL SILICONE:
  - 795 DOW CORNING
  - 983 DOW CORNING
  - SIKASIL SG-18
  - SIKASIL SG-500 CN

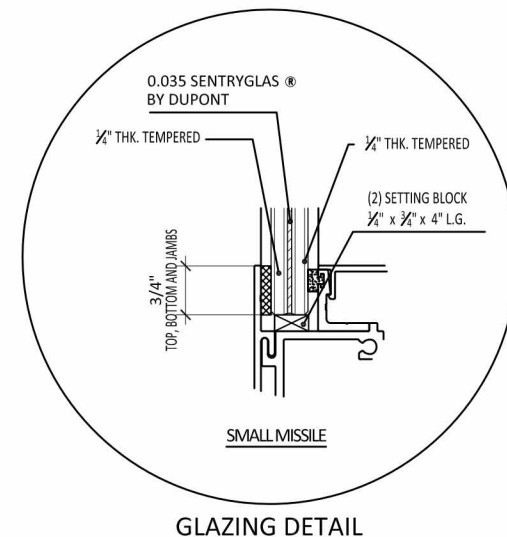
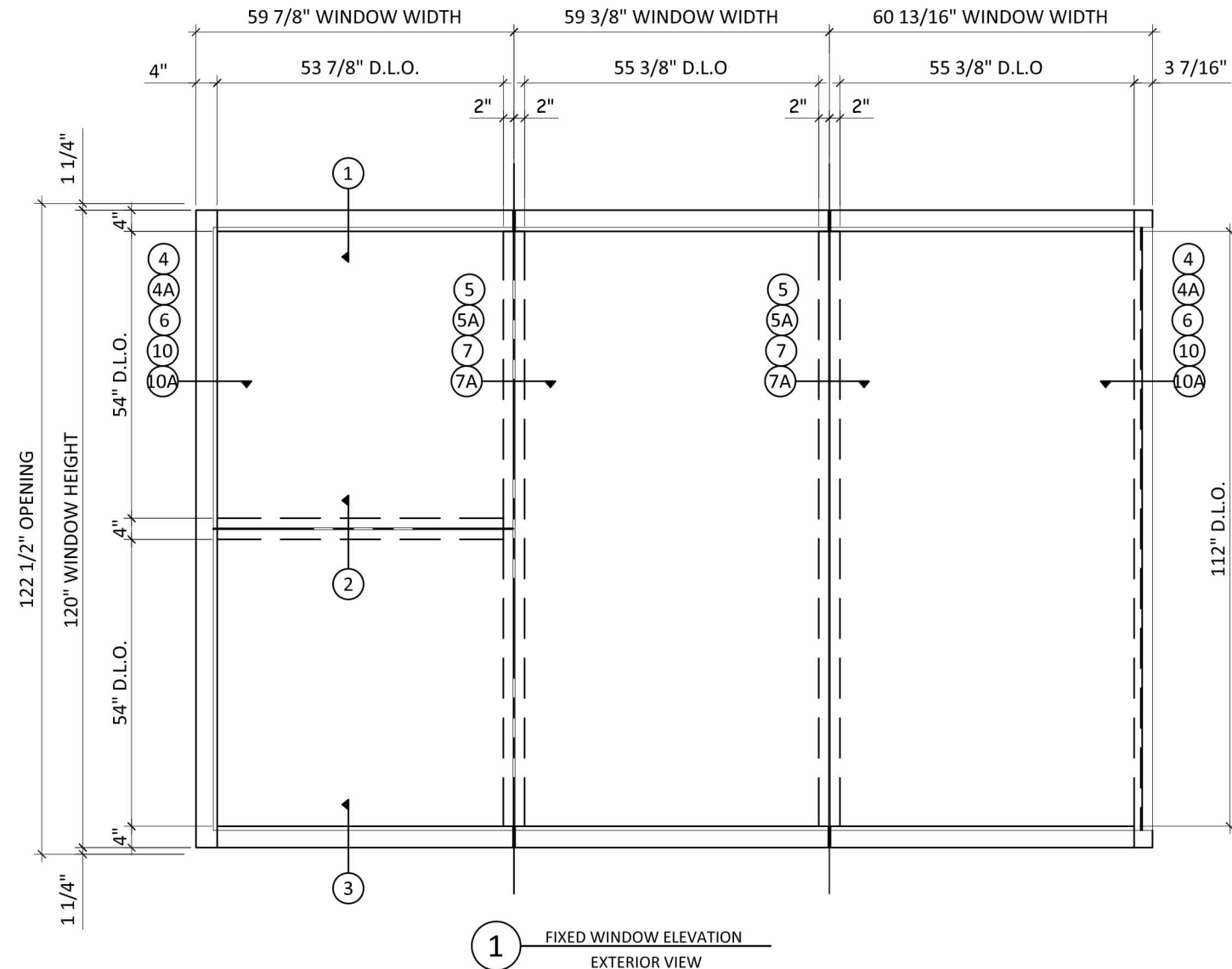

TABLE OF CONTENTS		
SHEET	REVISION	SHEET DESCRIPTION
1	A	GENERAL NOTES AND GLAZING DETAIL
2	A	ELEVATIONS AND ALLOWABLE CONFIGURATIONS
3	A	VERTICAL SECTIONS
4	A	STANDARD HORIZONTAL SECTIONS
5	A	ANGLED HORIZONTAL SECTIONS
6	A	ANCHOR LOCATIONS
7	A	SUBSTRATES
8	B	COMPONENTS, BILL OF MATERIALS AND CORNER ASSEMBLY

DESIGN PRESSURE RATING			
PANEL SIZE	REINFORCEMENT	DESIGN PRESSURE	MISSILE IMPACT RATING
60 13/16" x 120"	ALUMINUM	+/-180.0 PSF	SMALL MISSILE IMPACT *FOR INSTALLATIONS 30 FT ABOVE GRADE OR ABOVE
	ALUMINUM	+/-150.0 PSF	
	NONE	+/-120.0 PSF	
48 7/8" x 132"	ALUMINUM	+/-150.0 PSF	

Digitally signed by Hermes F Norero, P.E.  
Reason: I am approving this document  
Date: 2015.11.12 08:15:28 -05'00'



325 W. 74TH PLACE  
HIALEAH, FL 33014  
PH: (305) 231-1101 FX: (305) 231-1103

TITLE: SERIES 3800 WINDOW WALL (SMI) GENERAL NOTES AND GLAZING DETAIL

PREPARED BY: BUILDING DROPS, INC.  
398 E. DANIA BEACH BLVD. #3338  
DANIA BEACH, FL 33004  
PH: 954.399.8478 FX: 954.744.4738

REVISIONS	
NO.	DESCRIPTION
A	FBC 5TH EDITION REVISIONS
BY	DATE
LS	09.03.15



DATE: 08.14.14  
DWN BY: RV  
CHK BY: HFN  
SCALE: NTS

DWG #: CGS089

SHEET: 1 OF 8

# ALLOWABLE CONFIGURATIONS

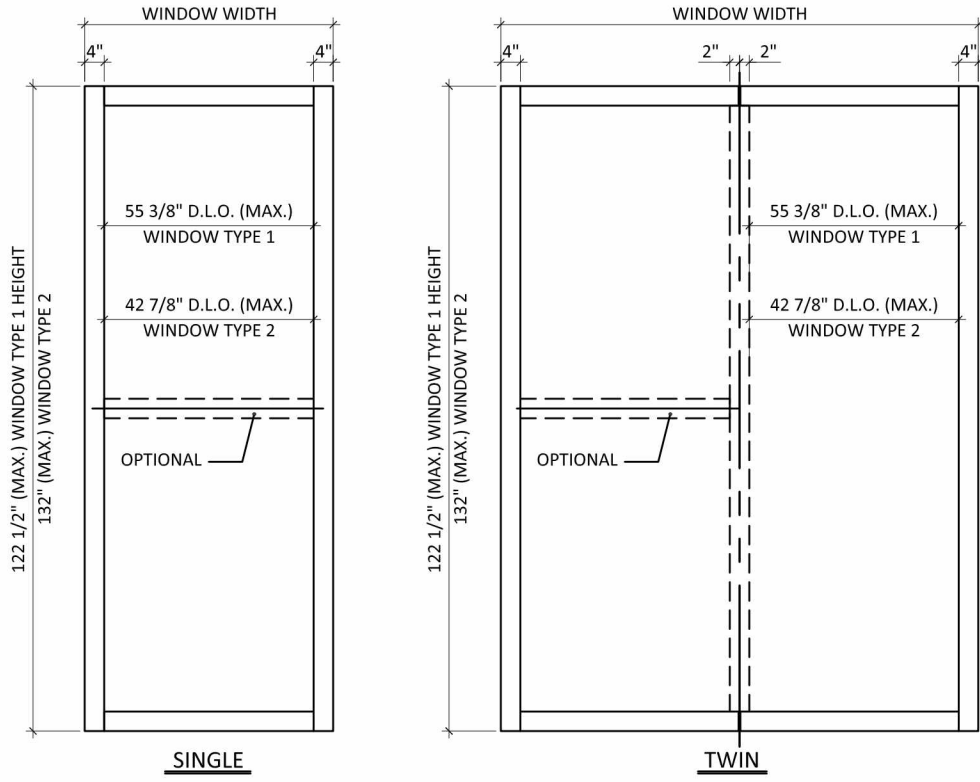
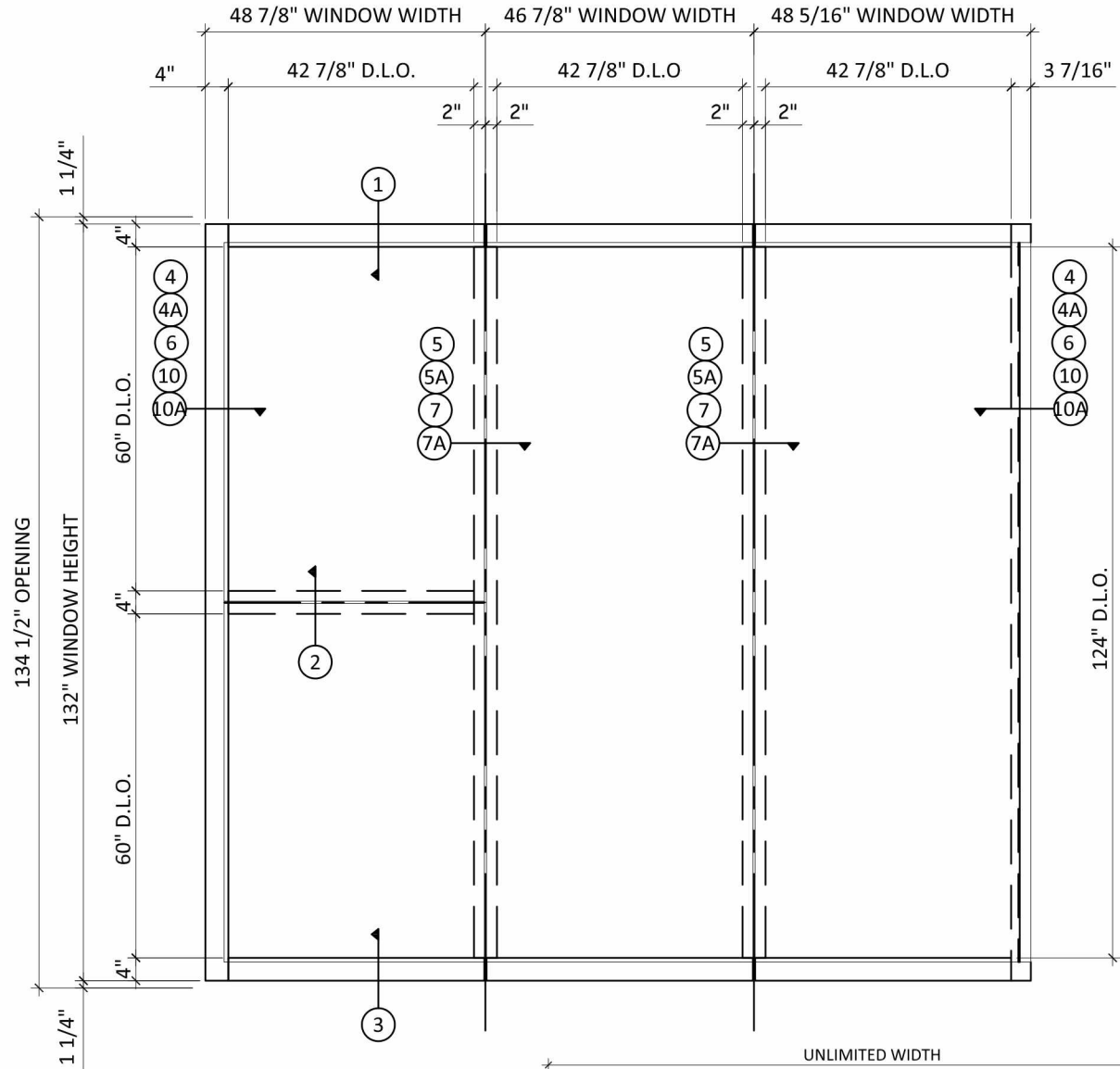

SMALL MISSILE IMPACT RATED ALUMINUM LOUVER UNDER SEPARATE APPROVAL

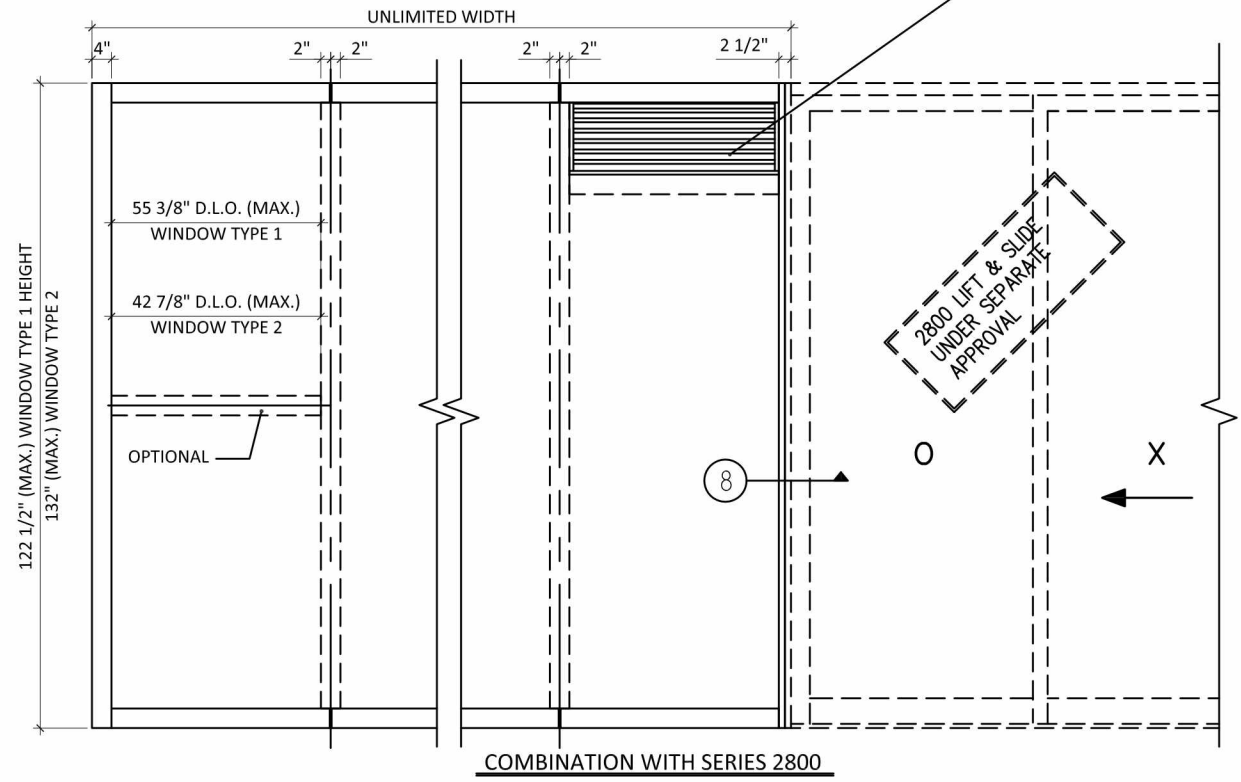
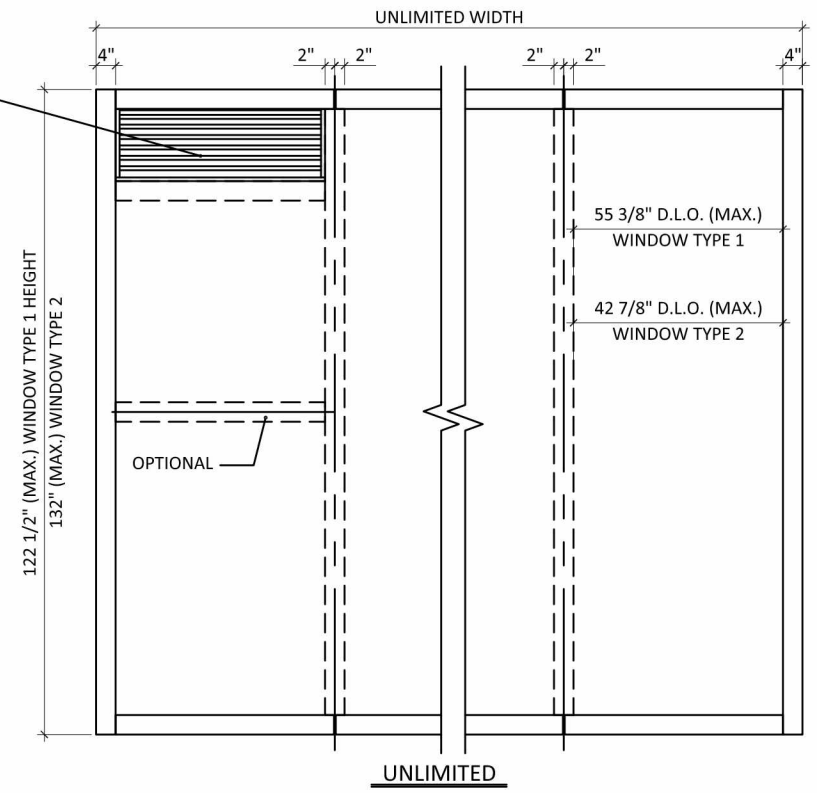

2 FIXED WINDOW ELEVATION EXTERIOR VIEW

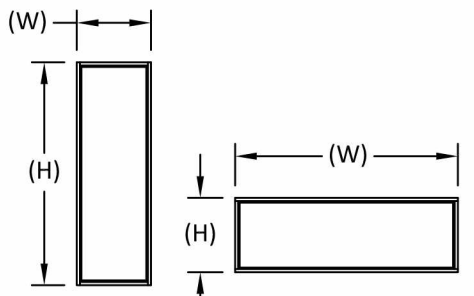

NOTE:  
WINDOW WIDTH (W) AND HEIGHT (H) ARE INTERCHANGEABLE FOR ALL SIZES SHOWN HEREIN NOT TO EXCEED MAXIMUM TESTED SQUARE FOOT AREA. ANCHOR SPACING SHALL NOT EXCEED THOSE SHOWN FOR LONG OR SHORT LEG OF UNIT.



325 W. 74TH PLACE  
HIALEAH, FL 33014  
PH: (305) 231-1101 FX: (305) 231-1103

TITLE: SERIES 3800 WINDOW WALL (SMI) ELEVATION AND ALLOWABLE CONFIGURATIONS  
PREPARED BY: BUILDING DROPS, INC. 398 E. DANIA BEACH BLVD. #338 DANIA BEACH, FL 33004 PH: 954-399-8478 FX: 954-744-4738

## REVISIONS

NO.	DESCRIPTION	BY	DATE
A	FBC 5TH EDITION REVISIONS	LS	09.03.15

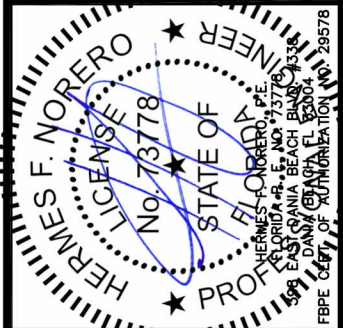

DATE: 08.14.14  
DWN BY: RV  
CHK BY: HFN  
SCALE: NTS

DWG #: CGS089

SHEET: 2 OF 8

TITLE: SERIES 3800 WINDOW WALL (SMI) VERTICAL SECTIONS  
 PREPARED BY: BUILDING DROPS, INC.  
 398 E. DANIA BEACH BLVD. #338  
 DANIA BEACH, FL 33004  
 PH: 954-399-8478 FX: 954-744-4738

REVISIONS		NO.	DESCRIPTION	BY	DATE
A	FBC 5TH EDITION REVISIONS	LS	09.03.15		

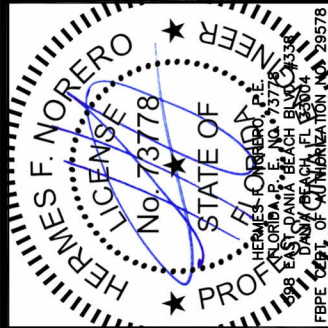

DATE: 08.14.14  
 DWN BY: RV  
 CHK BY: HFN  
 SCALE: NTS

DWG #: CGS089

SHEET: 3 OF 8

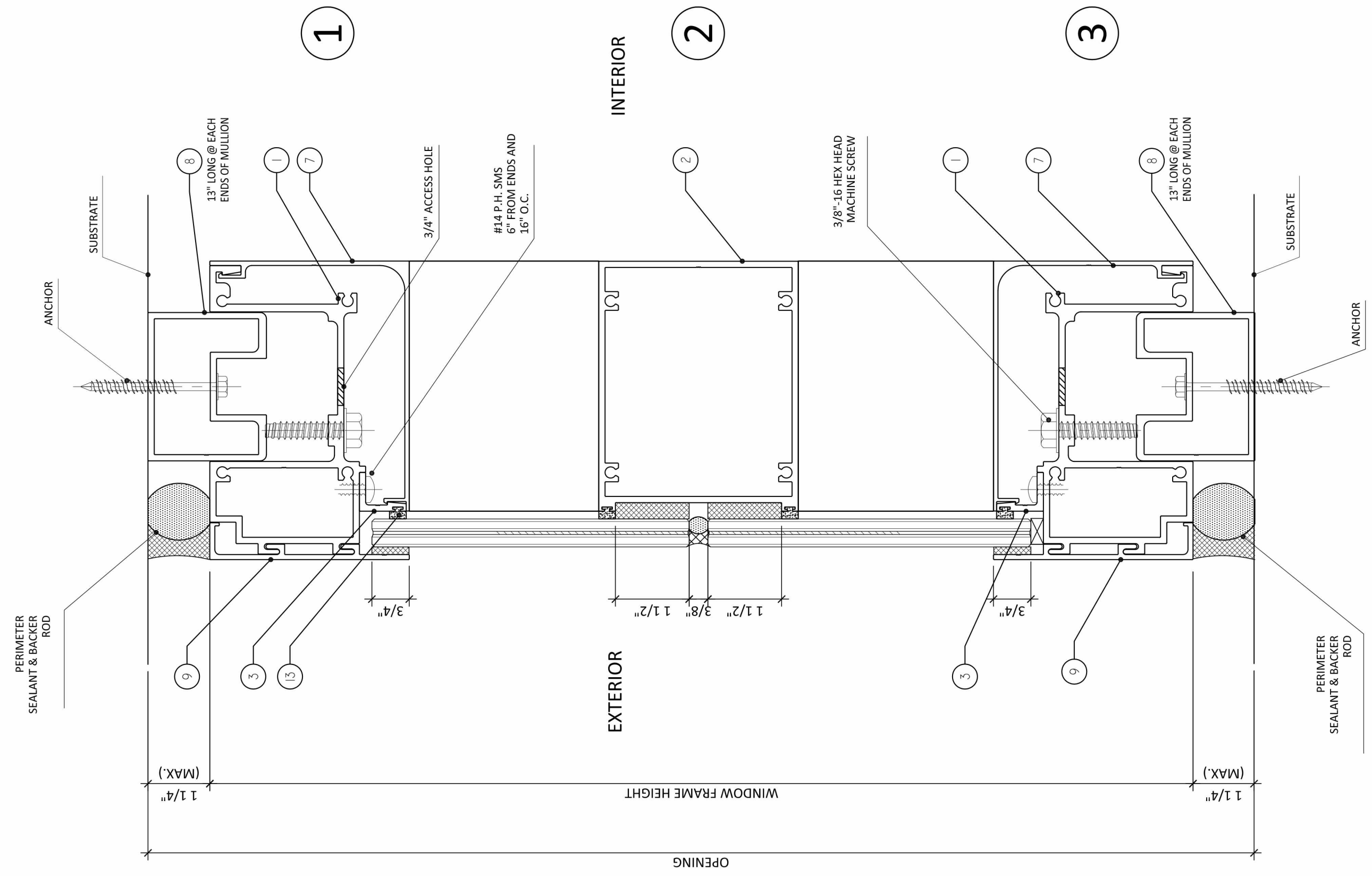

DATE: 08.14.14  
 DWN BY: RV  
 CHK BY: HFN  
 SCALE: NTS

DWG #: CGS089

SHEET: 3 OF 8

TITLE: SERIES 3800  
WINDOW WALL (SMT)  
STANDARD HORIZONTAL  
SECTIONS

PREPARED BY:  
BUILDING DROPS, INC.  
398 E. DANIA BEACH BLVD. #338  
DANIA BEACH, FL 33004  
PH: 954.399.8478 FX: 954.744.4738

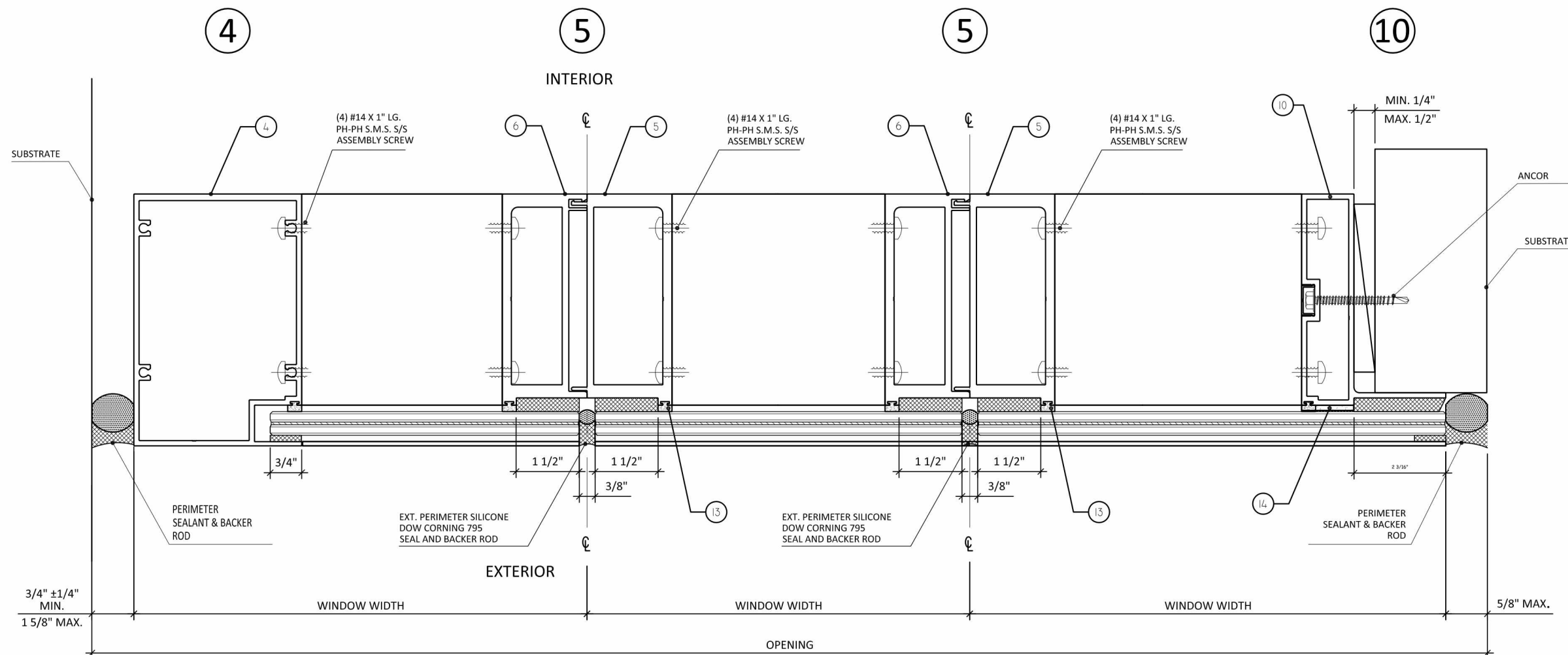

**NOTES:**  
1- BACKER ROD DIAMETER  
EQUALS SEAL WIDTH x 120%  
2- SEALANT DEPTH IS:  
1/2" FOR WIDTHS UP TO 1" AND  
5/8" FOR WIDTHS OVER 1".

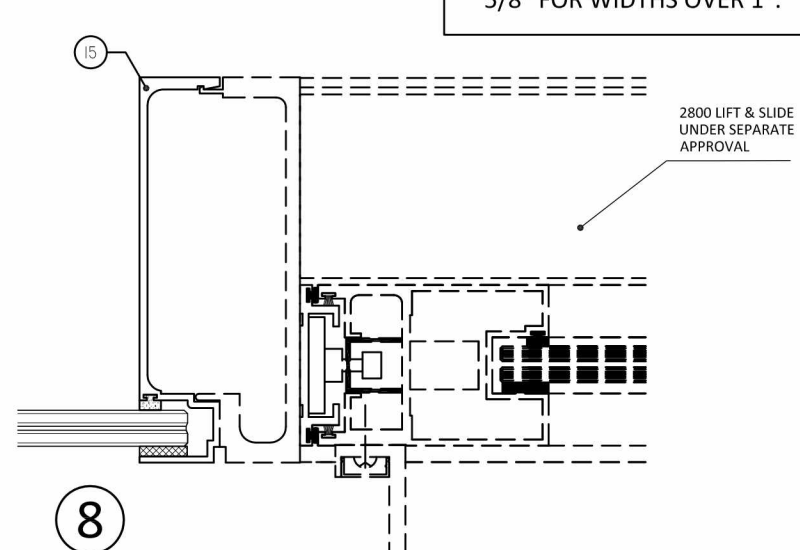
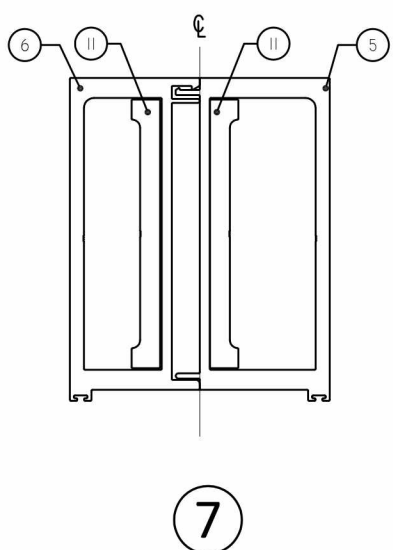
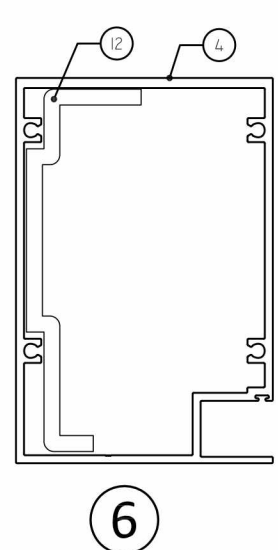
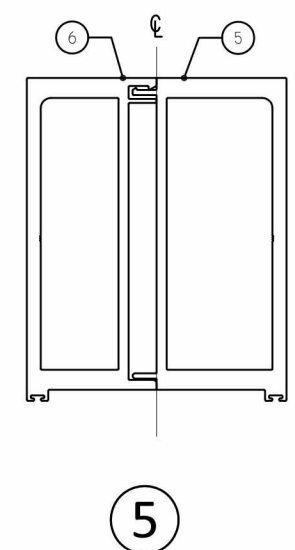
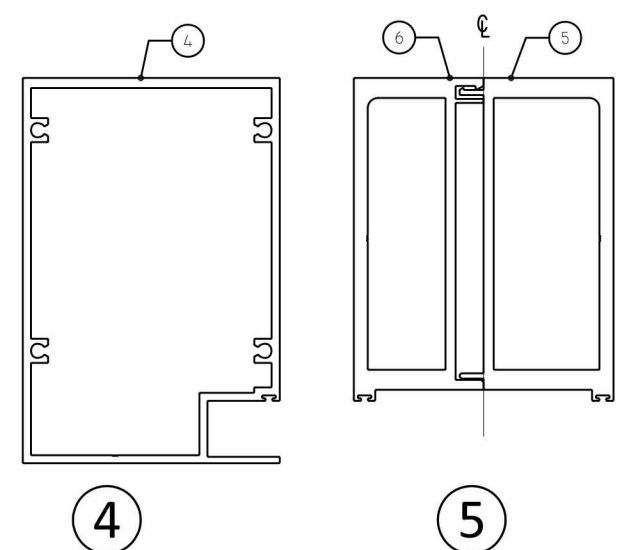

**REVISIONS**

NO.	DESCRIPTION	BY	DATE
A	FBC 5TH EDITION REVISIONS	LS	09.03.15



DATE: 08.14.14  
DWN BY: RV  
CHK BY: HFN  
SCALE: NTS

DWG #: CGS089

SHEET: 4 OF 8

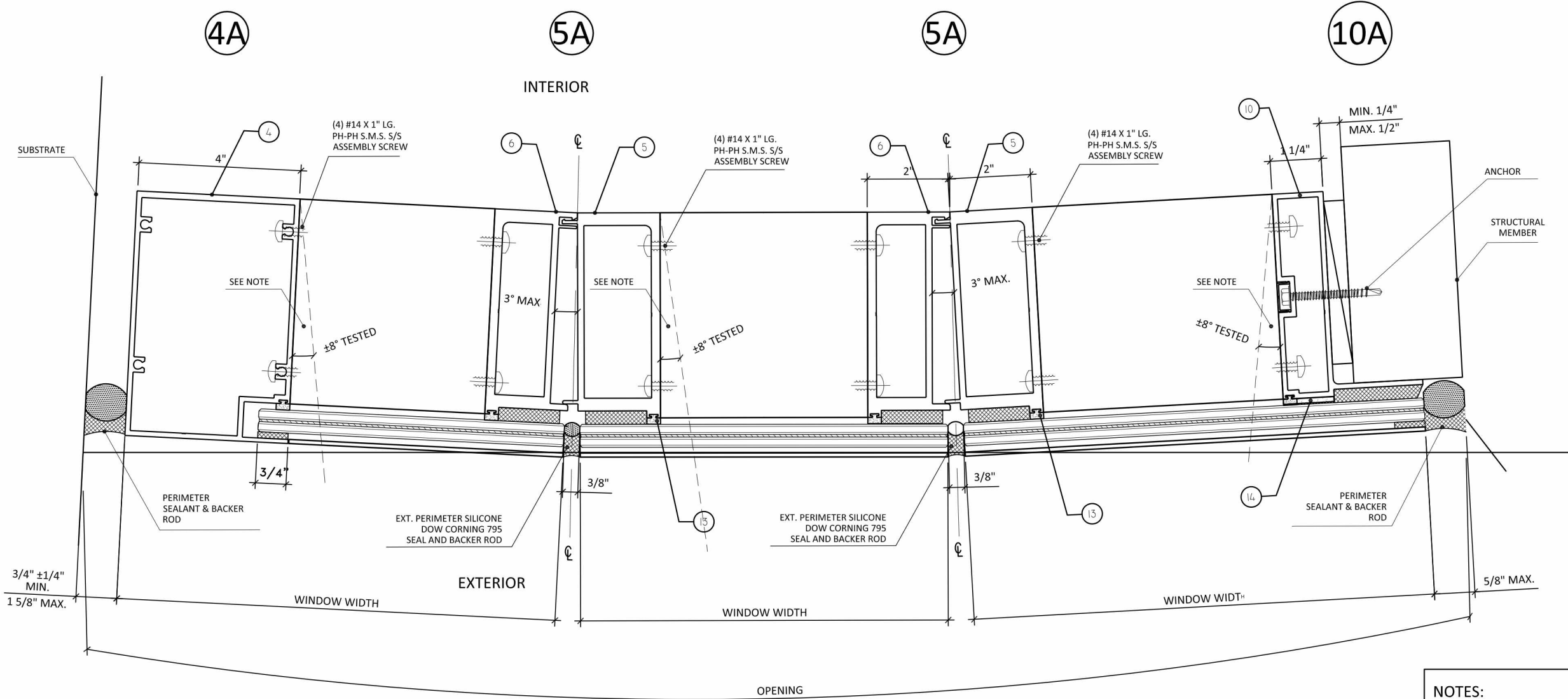

**NOTES:**  
 1- BACKER ROD DIAMETER  
 EQUALS SEAL WIDTH x 120%  
 2- SEALANT DEPTH IS:  
 1/2" FOR WIDTHS UP TO 1" AND  
 5/8" FOR WIDTHS OVER 1".

**NOTE:**  
 THE HEAD, SILL & INTERMEDIATE  
 MEMBERS MITER UP TO 8°

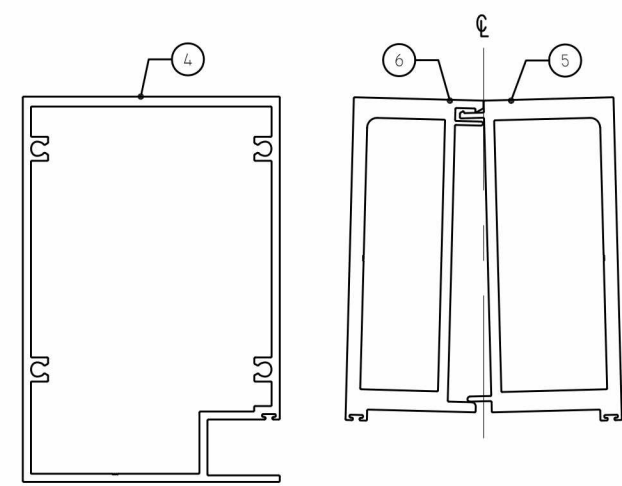

**4A**  
**UNREINFORCED VERTICALS**  
 UP TO 150 PSF

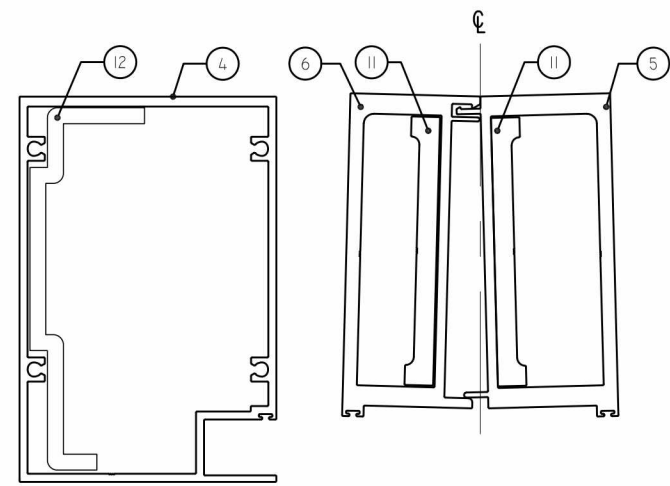

**6**  
**REINFORCED VERTICALS**  
 UP TO 180 PSF

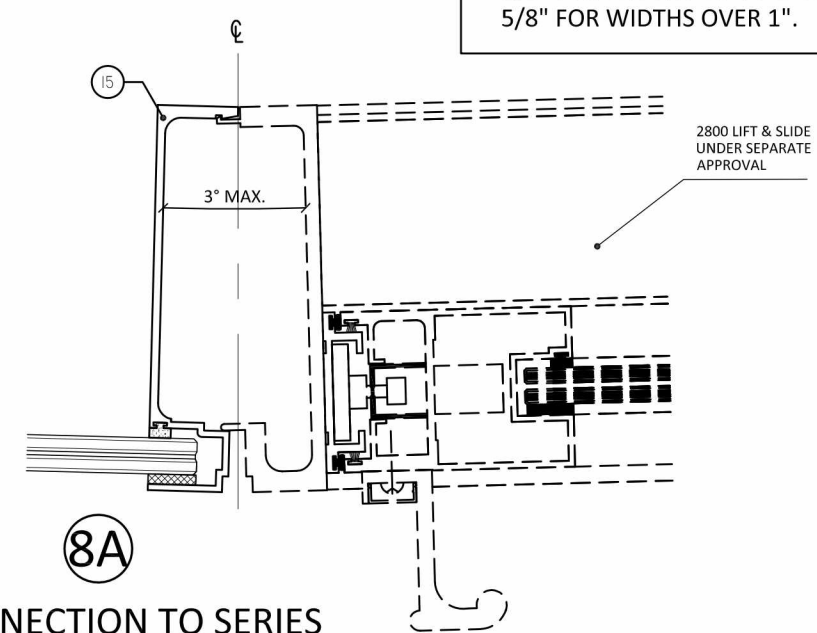

**8A**  
**CONNECTION TO SERIES**  
**2800 LIFT & SLIDE**

**TITLE:** SERIES 3800 WINDOW WALL (SMI)  
**ANGLED HORIZONTAL SECTIONS**  
**PREPARED BY:** BUILDING DROPS, INC.  
 398 E. DANIA BEACH BLVD. #338  
 DANIA BEACH, FL 33004  
 PH: 954.399.8478 FX: 954.744.4738

REVISIONS		NO.	DESCRIPTION	BY	DATE
A	FBC 5TH EDITION REVISIONS	LS			09.03.15

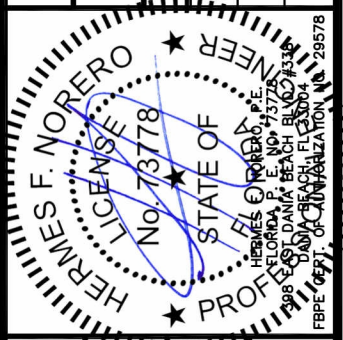

DATE: 08.14.14  
 DWN BY: RV  
 CHK BY: HFN  
 SCALE: NTS

DWG #: CGS089

SHEET: 5 OF 8

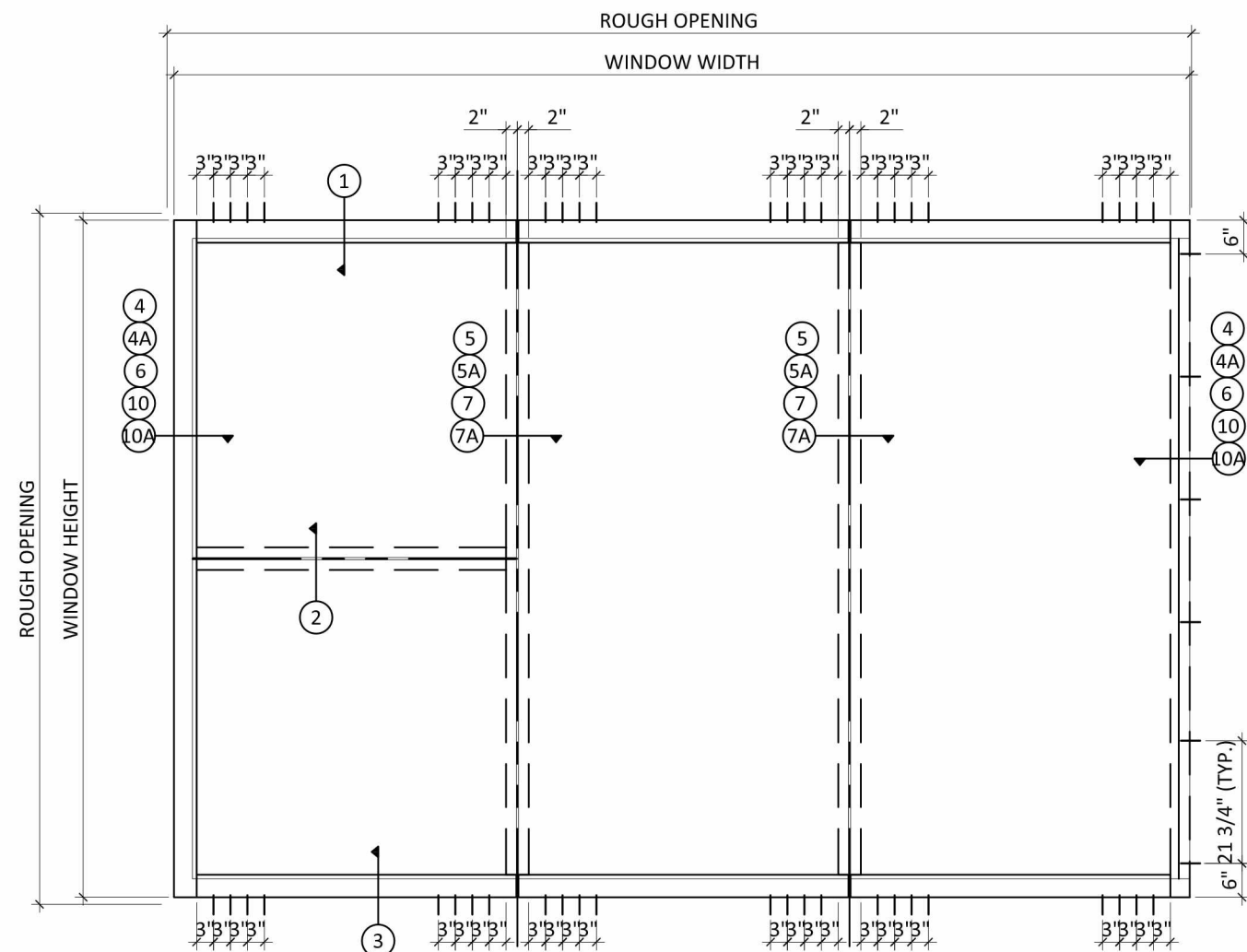

FIXED WINDOW ELEVATION  
EXTERIOR VIEW

**INSTALLATION NOTES:**

- ONE (1) INSTALLATION ANCHORS ON HEAD AND ONE (1) INSTALLATION ANCHOR ON SILL FOR EACH ANCHOR LOCATION SHOWN.
- THE NUMBER OF INSTALLATION ANCHORS DEPICTED IS THE MINIMUM NUMBER OF ANCHORS TO BE USED FOR PRODUCT INSTALLATION.
- INSTALL INDIVIDUAL INSTALLATION ANCHORS WITHIN A TOLERANCE OF ±1/2 INCH OF THE DEPICTED LOCATION IN THE ANCHOR LAYOUT DETAIL (I.E., WITHOUT CONSIDERATION OF TOLERANCES). TOLERANCES ARE NOT CUMULATIVE FROM ONE INSTALLATION ANCHOR TO THE NEXT.
- SHIM AS REQUIRED AT EACH INSTALLATION ANCHOR WITH LOAD BEARING SHIM(S). MAXIMUM ALLOWABLE SHIM STACK TO BE 1/4 INCH. SHIM WHERE SPACE OF 1/16 INCH OR GREATER OCCURS. SHIM(S) SHALL BE CONSTRUCTED OF HIGH DENSITY PLASTIC OR BETTER.
- FOR INSTALLATION DIRECTLY INTO CONCRETE/MASONRY, USE 5/16 INCH DIAMETER ELCO ULTRACON OF SUFFICIENT LENGTH TO ACHIEVE 1 3/4 INCH MINIMUM EMBEDMENT.
- FOR INSTALLATION DIRECTLY INTO WOOD FRAME, USE #14 WOOD SCREWS OF SUFFICIENT LENGTH TO ACHIEVE 1 1/2 INCH MINIMUM EMBEDMENT.
- FOR INSTALLATION DIRECTLY INTO STEEL FRAME, USE 1/4" DIAMETER PT 5 GRADE 5 TEKS SELECT SCREWS OF SUFFICIENT LENGTH TO ACHIEVE 3 THREADS MINIMUM PENETRATION BEYOND METAL FRAME SUBSTRATE.
- MINIMUM EMBEDMENT AND EDGE DISTANCE EXCLUDE WALL FINISHES, INCLUDING BUT NOT LIMITED TO STUCCO, FOAM, BRICK VENEER, AND SIDING.
- INSTALLATION ANCHORS AND ASSOCIATED HARDWARE MUST BE MADE OF CORROSION RESISTANT MATERIAL OR HAVE A CORROSION RESISTANT COATING.
- FOR HOLLOW BLOCK AND GROUT FILLED BLOCK, DO NOT INSTALL INSTALLATION ANCHORS INTO MORTAR JOINTS. EDGE DISTANCE IS MEASURED FROM FREE EDGE OF BLOCK OR EDGE OF MORTAR JOINT INTO FACE SHELL OF BLOCK.
- INSTALLATION ANCHORS SHALL BE INSTALLED IN ACCORDANCE WITH ANCHOR MANUFACTURER'S INSTALLATION INSTRUCTIONS, AND ANCHORS SHALL NOT BE USED IN SUBSTRATES WITH STRENGTHS LESS THAN THE MINIMUM STRENGTH SPECIFIED BY THE ANCHOR MANUFACTURER.
- INSTALLATION ANCHOR CAPACITIES FOR PRODUCTS HEREIN ARE BASED ON SUBSTRATE MATERIALS WITH THE FOLLOWING PROPERTIES:
  - WOOD - MINIMUM SPECIFIC GRAVITY OF 0.55.
  - CONCRETE - MINIMUM COMPRESSIVE STRENGTH OF 3000 PSI.
  - GROUT-FILLED CMU- UNIT STRENGTH CONFORMS TO ASTM C-90 WITH MINIMUM COMPRESSIVE STRENGTH OF 2000 PSI AND GROUT CONFORMS TO ASTM C 476, MINIMUM GROUT COMPRESSIVE STRENGTH OF 2000 PSI.
  - HOLLOW BLOCK CMU - UNIT STRENGTH CONFORMS TO ASTM C-90 WITH MINIMUM COMPRESSIVE STRENGTH OF 2000 PSI.
  - STEEL - MINIMUM YIELD STRENGTH OF 33 KSI. MINIMUM 16 GA. (0.0598") MAX. 1/2" WALL THICKNESS.
  - ALUMINIUM - 6063-T6 MINIMUM YIELD STRENGTH OF 25 KSI. MINIMUM .25" WALL THICKNESS.

TITLE: SERIES 3800 WINDOW WALL (SMI) ANCHOR LOCATIONS  
 PREPARED BY: BUILDING DROPS, INC.  
 398 E. DANIA BEACH BLVD. #338  
 DANIA BEACH, FL 33004  
 PH: 954.399.8478 FX: 954.744.4738

REVISIONS		NO.	DESCRIPTION	BY	DATE
A	FBC 5TH EDITION REVISIONS	LS	09.03.15		

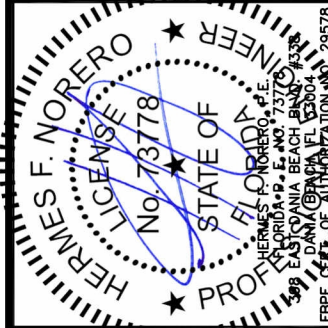

DATE: 08.14.14  
 DWN BY: RV  
 CHK BY: HFN  
 SCALE: NTS

DWG #: CGS089

SHEET: 6 OF 8

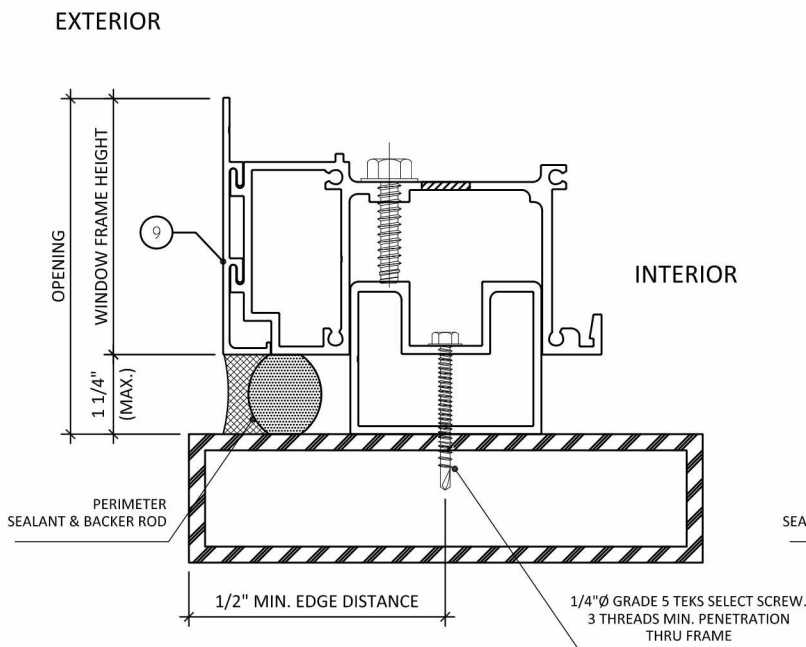

**ALUMINUM TUBE**  
HEAD & SILL

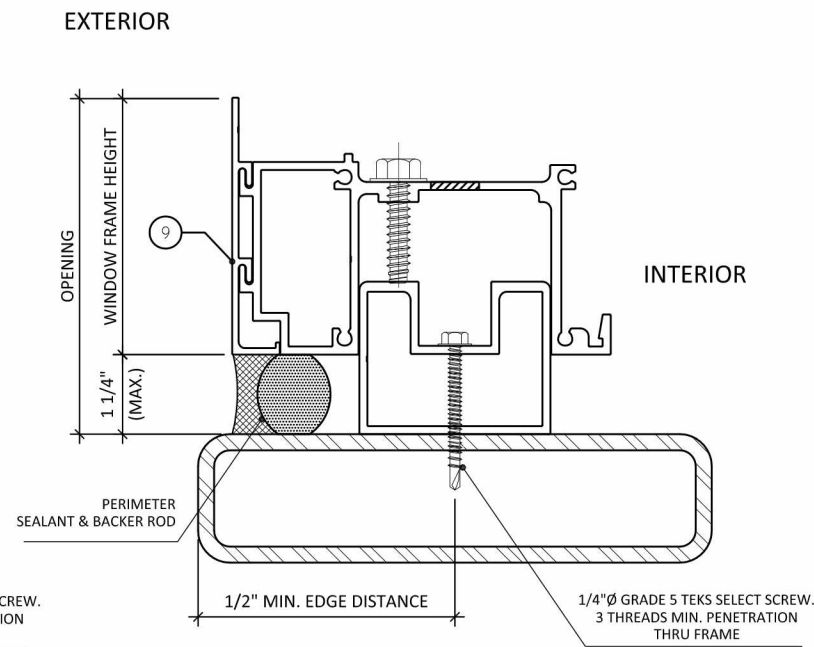

**STEEL TUBE**  
HEAD & SILL

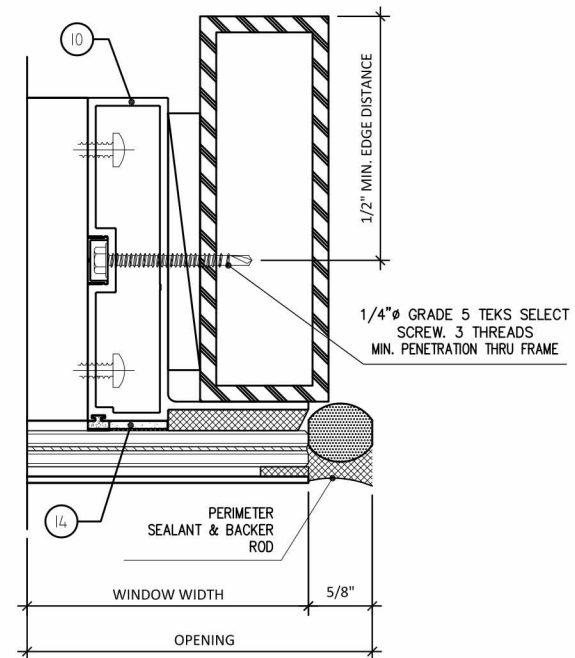

**ALUMINUM TUBE**  
ANCHORED JAMB

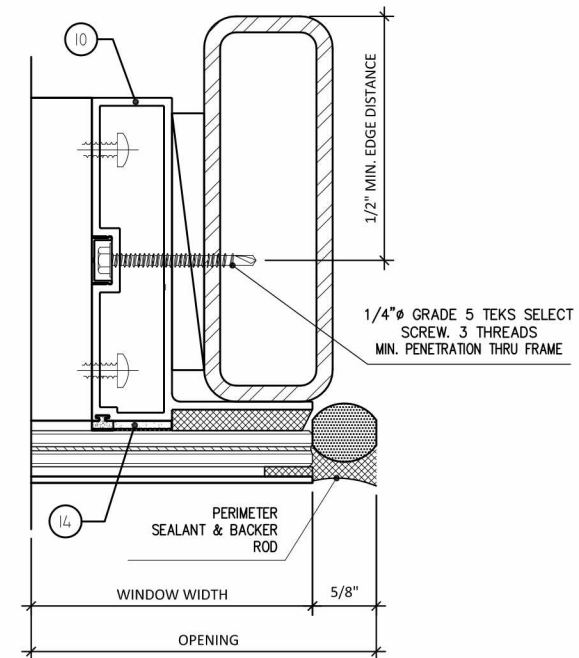

**STEEL TUBE**  
ANCHORAGE JAMB

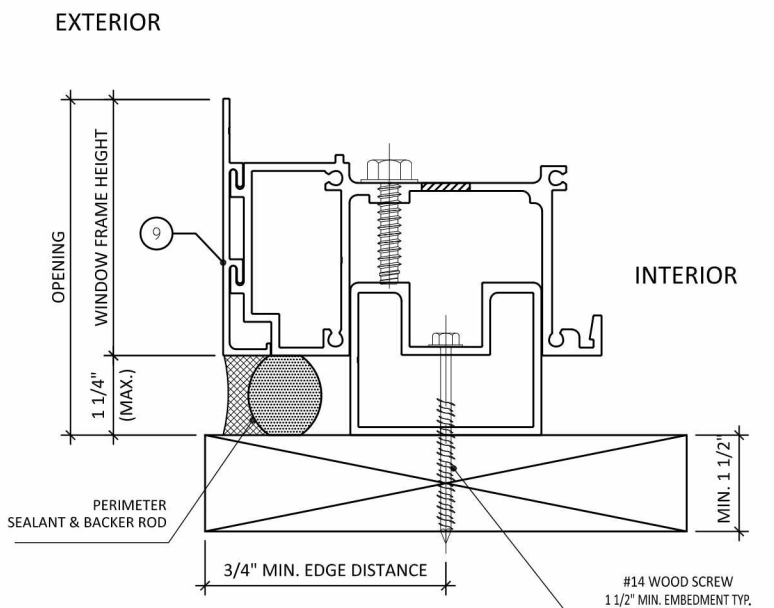

**PT WOOD BUCK**  
HEAD & SILL

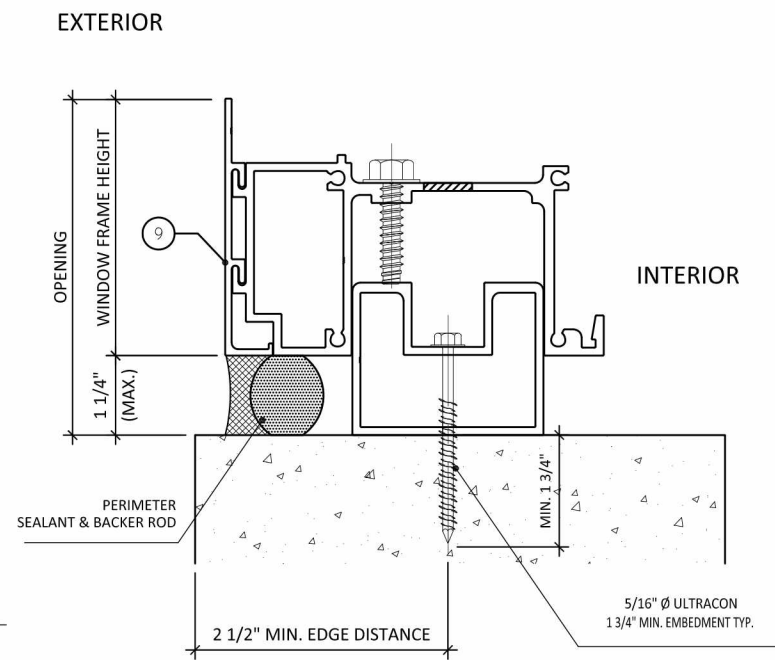

**MASONRY**  
HEAD & SILL

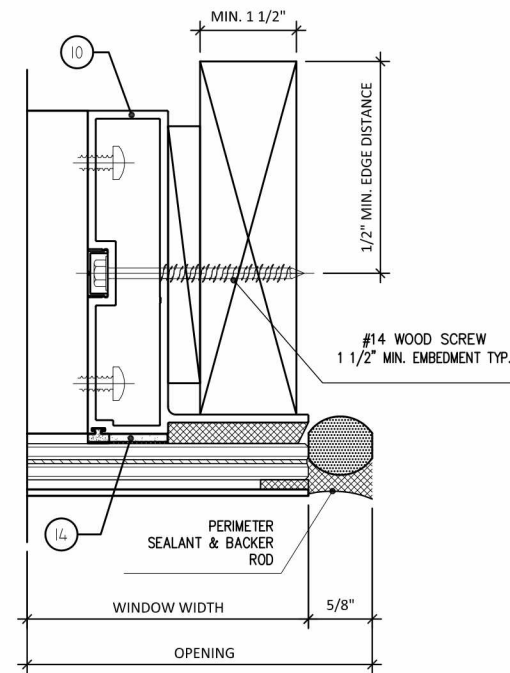

**PT WOOD BUCK**  
ANCHORED JAMB

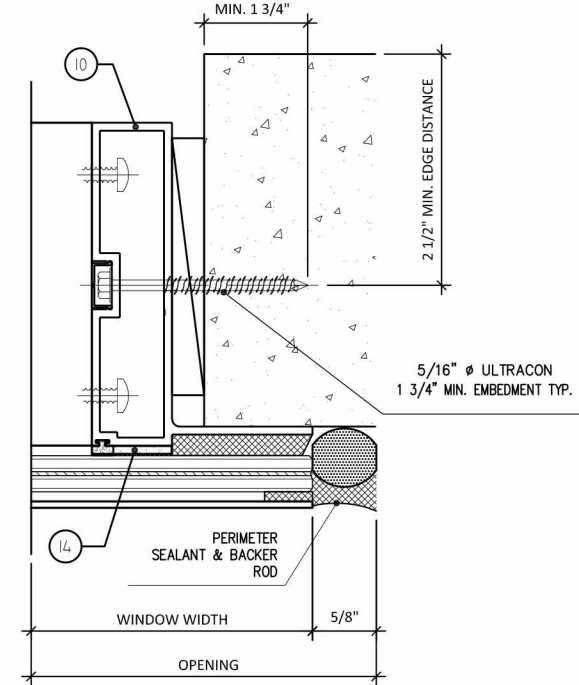

**MASONRY**  
ANCHORAGE JAMB

TITLE: SERIES 3800  
WINDOW WALL (SMI)

SUBSTRATES

PREPARED BY:  
BUILDING DROPS, INC.  
398 E. DANIA BEACH BLVD. #338  
DANIA BEACH, FL 33004  
PH: 954.399.8478 FX: 954.744.4738

**REVISIONS**

NO.	DESCRIPTION	BY	DATE
A	FBC 5TH EDITION REVISIONS	LS	09.03.15

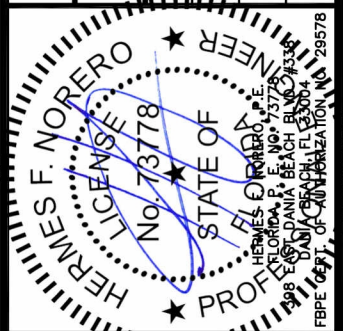

DATE:	08.14.14
DWN BY:	RV
CHK BY:	HFN
SCALE:	NTS

DWG #: CGS089

SHEET: 7 OF 8

1 3800-01 - HEAD & SILL

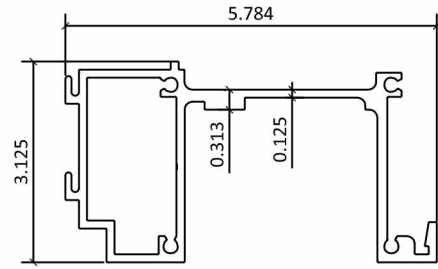

2 3800-02 - INTERMEDIATE HORIZONTAL

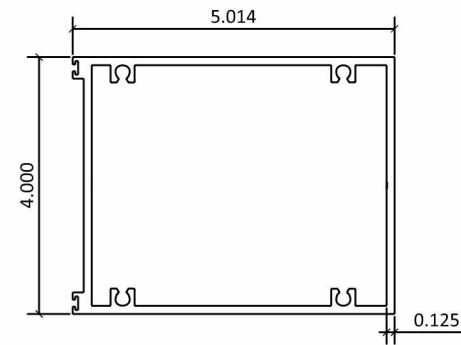

3 3800-03 - GLAZING BEAD

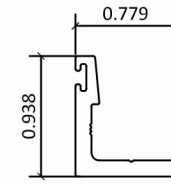

4 3800-04 - JAMB MULL

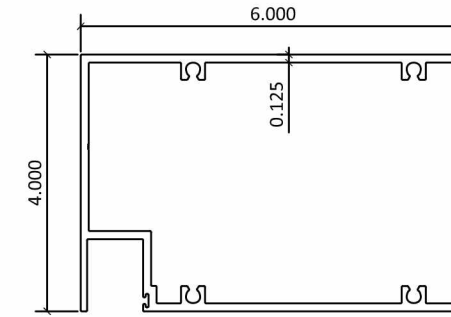

5 3800-05 - MALE MULLION

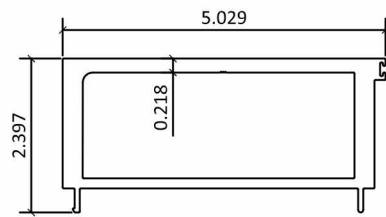

6 3800-06 - FEMALE MULLION

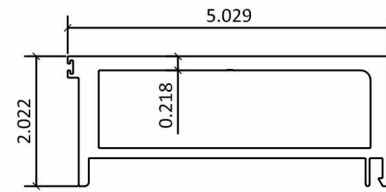

7 3800-07 - INTERIOR COVER

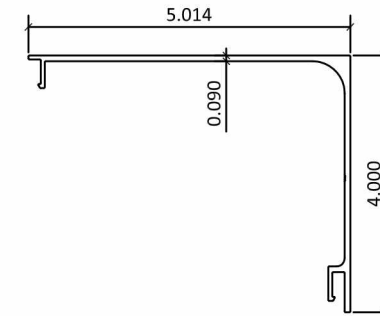

8 3800-08 - ANCHORING TUBE (13" LONG)

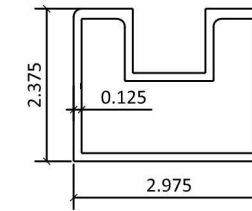

9 3800-09 - TOP & BOTTOM FACE COVER

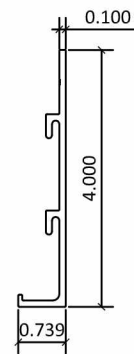

10 3800-10 - SMALL JAMB

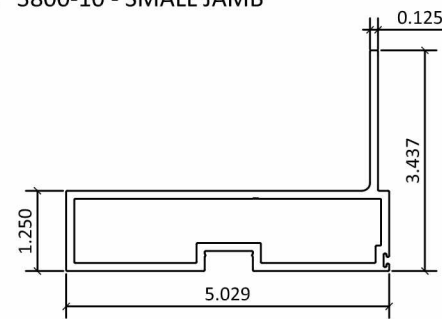

11 3800-21 - INTERMEDIATED ALUM. REINFORCEMENT

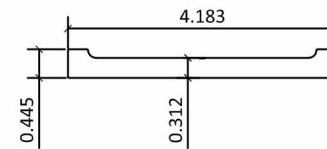

12 3800-15 - JAMB REINFORCEMENT

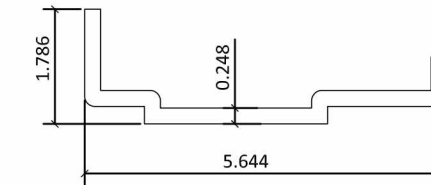

15 3000-06 - FEMALE

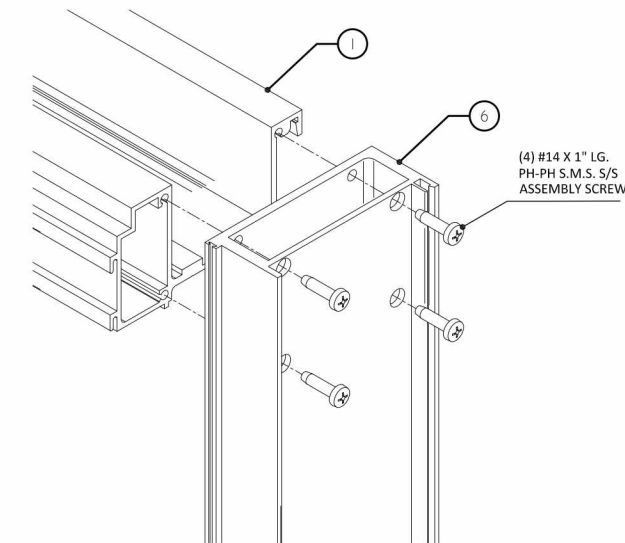
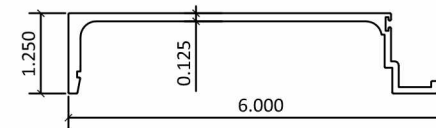

CORNER CONNECTION

BILL OF MATERIALS				
ITEM #	PART NUMBER	PART NAME	ALLOY & TEMPERED	REMARKS
1	3800-01	HEAD & SILL	6005-T5	
2	3800-02	INTERMEDIATE HORIZONTAL	6005-T5	
3	3800-03	GLAZING BEAD	6005-T5	
4	3800-04	JAMB MULLION	6005-T5	
5	3800-05	MALE MULLION	6005-T5	
6	3800-06	FEMALE MULLION	6005-T5	
7	3800-07	INTERIOR COVER	6005-T5	
8	3800-08	ANCHOR TUBE (13" LONG)	6005-T5	
9	3800-09	TOP & BOTTOM FACE COVER	6005-T5	
10	3800-10	SMALL JAMB MULLION	6005-T5	
11	3800-21	MULLION ALUMINUM REINFORCEMENT	6005-T5	
12	3000-15	JAMB REINFORCEMENT	6005-T5	
13	CGS-02	GLASS SPACER		CENTRAL PLASTIC
14		SPACING GASKET		CENTRAL PLASTIC
15	3000-06	FEMALE	6005-T5	



325 W. 74TH PLACE  
HIALEAH, FL 33014  
PH: (305) 231-1101 FX: (305) 231-1103

TITLE: SERIES 3800 WINDOW WALL (SMT) COMPONENTS AND BILL OF MATERIALS  
PREPARED BY: BUILDING DROPS, INC.  
398 E. DANIA BEACH BLVD. #338  
DANIA BEACH, FL 33004  
PH: 954.399.8478 FX: 954.744.4738

NO.	DESCRIPTION	BY	DATE
		LS	09.03.15
A	FBC 5TH EDITION REVISIONS	SM	11.03.15
B	DIE SIZE CORRECTIONS		



DATE: 08.14.14  
DWN BY: RV  
CHK BY: HFN  
SCALE: NTS

DWG #: CGS089

SHEET: 8 OF 8